

4

3

2

1

B

B

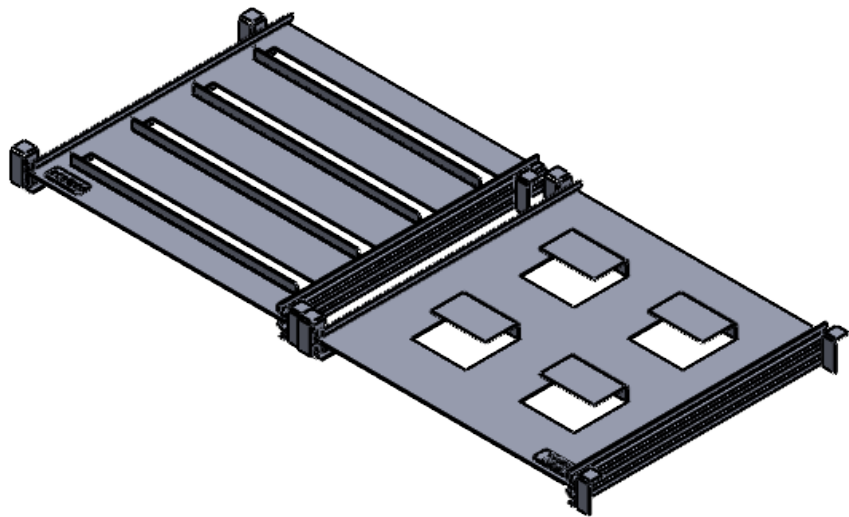
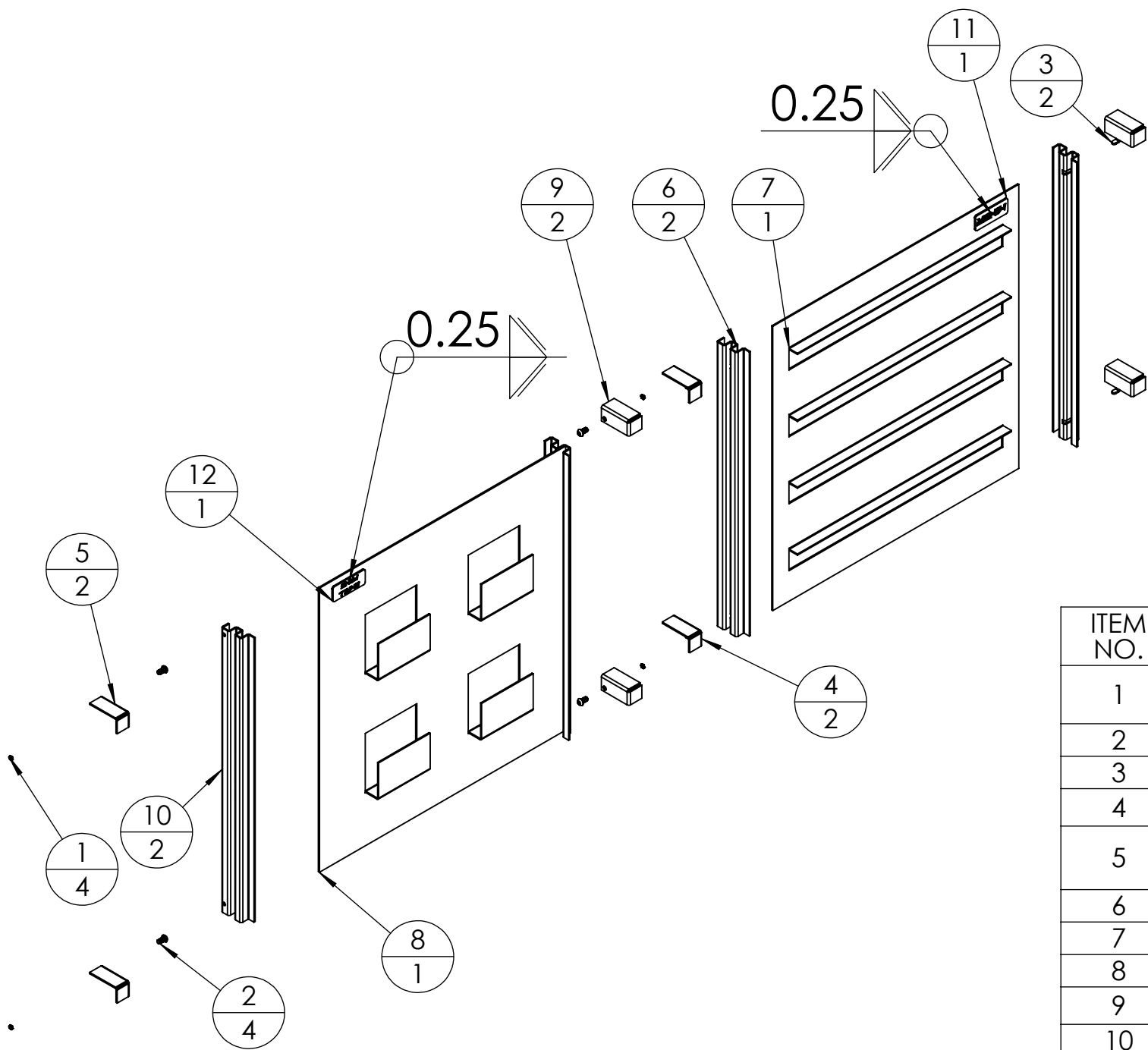

ITEM NO.	PART NUMBER	DESCRIPTION	QTY.
1	003-00100-001	NUT, PRESS FIT, 6-32, FOR 0.062 MIN PANEL THICKNESS	4
2	003-00101-001	DRIVE SCREW, BH, M6X1, 12mm, 18-8 SS	4
3	003-00013-001	MOUNT, LEFT, MINER, FULL SERVER RACK	2
4	003-00014-001	MOUNT, RIGHT, MINER, FULL SERVER RACK	2
5	003-00032-001	MOUNT, RIGHT, SMALL FAN SLOT, FULL SERVER RACK	2
6	003-00079-001	SIDE BRACE, MINER, FULL SERVER RACK	2
7	003-00043-001	SHELF, MINER, FULL SERVER RACK	1
8	003-00052-001	SHELF, SMALL FAN SLOT, FULL SERVER RACK	1
9	003-00029-001	MOUNT, LEFT, LARGE VENTS, FULL SERVER RACK	2
10	003-00088-001	SIDE BRACE, SMALL FAN SLOT, FULL SERVER RACK	2
11	003-00061-001	NAMEPLATE, MINER, FULL SERVER RACK	1
12	003-00070-001	NAMEPLATE, SMALL FAN SLOT, FULL SERVER RACK	1

NOTES: UNLESS OTHERWISE SPECIFIED.  
1. PARAMETRIC MODEL. ALL DIMENSIONS FURTHER SPECIFIED IN 003-00109.  
2. ASSEMBLY SHALL NOT BE MODIFIED BY ANY PARTY OUTSIDE PAPERLESS PARTS, INC UNLESS WRITTEN OR EXPRESS APPROVAL HAS BEEN PERMITTED FOR THE ASSEMBLY.

<div>UNLESS OTHERWISE SPECIFIED:</div> <div>DIMENSIONS ARE IN INCHES</div> <div>TOLERANCES:</div> <div>ANGULAR: MACH ± 1.0°</div> <div>BEND ± 0.5°</div> <div>ONE PLACE DECIMAL ± 0.1</div> <div>TWO PLACE DECIMAL ± 0.05</div>	DRAWN		NAME	DATE	<div><div>paperlessPARTS</div><div></div></div> <div>TITLE:</div> <div>SEVENTH RACK, FULL SERVER RACK</div> <div><div>SIZE</div><div>DWG. NO.</div><div>REV</div><div>B</div><div>003-00109</div><div>001</div></div> <div><div>SCALE: NTS</div><div>WEIGHT: SEE MODEL</div><div>SHEET 1 OF 1</div></div>		
	CHECKED		NM	8/30/2024			
	ENG APPR.						
	MFG APPR.						
	Q.A.						
COMMENTS:		<div></div>					
MATERIAL							
FINISH							
DO NOT SCALE DRAWING							
<div>PROPRIETARY AND CONFIDENTIAL</div> <div>THE INFORMATION CONTAINED IN THIS DRAWING IS THE SOLE PROPERTY OF PAPERLESS PARTS, INC. ANY REPRODUCTION IN PART OR AS A WHOLE WITHOUT THE WRITTEN PERMISSION OF PAPERLESS PARTS, INC IS PROHIBITED.</div>	INTERPRET GEOMETRIC TOLERANCING PER: ASME Y14.5						